



There are certain things you expect for your business...at the Clanard Court Hotel we added more

Independently owned hotel...

Giving us and you more flexibility to be different from the rest.

Modern, elegant, boutique style...

All our rooms have been designed with your business in mind.

Exceptional staff...

From friendliness to cleanliness our staff excel in their fields and deliver more than you'd expect.

Spacious, welcoming foyer...

Just one of our places to meet and greet colleagues.

The latest plug and play technology...

Plasma screens, integrated projectors, complimentary broadband access – all part of our in-house equipment to ensure a modern, successful business presentation at less cost.

Private outdoor patio...

A beautifully manicured garden or even a golf putting green for you to enjoy at break time. Furthermore we have additional outdoor areas which may be used for activities such as team building etc.

Large free car parking area...

Bigger than most so none of your guests are left on the roadside. Also suitable for displaying large machinery or equipment.

Perfectly placed...

the Dublin Road, Athy gives a speedy link to many major routes. Just 40 minutes from Dublin. A central link to Dublin, Carlow, Laois and Kilkenny.

Bored with boardrooms?

If you want that 'wow factor' we can team up with you to organise something really different - team building events, product launches, corporate entertainment.

CLANARD COURT HOTEL
Dublin Road, Athy, Co. Kildare

T: 059 8640666 • **E:** sales@clanardcourt.ie • **W:** www.clanardcourt.ie

“Our Thanks to You” Rewards and Loyalty Scheme

Loyalty Scheme

Accommodation Loyalty Card

For every 9 nights accommodation at full Corporate Rate receive your 10th night accommodation free or choose a free gift.

Conference / Meeting Room Loyalty Card

For every 9 meetings / conferences booked, paying full room hire charges receive your 10th meeting / conference room hire free.

Bookers Rewards Scheme

Your loyalty is valued by us and to show our appreciation we have something for the bookers as well.

At the end of the calendar year we will review all the bookings you have made with us; and based on volume of business we have received our gift to you could be:

A wine hamper, A meal with our compliments, A television, A Spa Break, A holiday Or one of the many other Thank You's we have available.

Terms & Conditions apply. Not applicable with any other discounts.

Special Corporate Rate

From €69 per night Bed & Breakfast (Single)

En-suite Bathroom & Power Shower

Free High Speed Broadband

Interactive TV

In Room Safe

Trouser Press & Iron

Mini Bar Available on Request

Hair Dryer

6ft Deluxe Beds

Clanard Court Hotel Delegate Rates

For bespoke meeting requirements please contact our Sales Office

Daily Delegate Rate €33

- Hire of Conference Room with Natural Light & WiFi
- Standard Equipment & Stationery
- Iced Water
- Morning Tea & Coffee served with Pastries
- Light Lunch
- Daily Newspaper in Meeting Rooms
- Afternoon Tea/Coffee served with Homemade Cookies
- Reserved Car Parking for Organiser

Executive Delegate Rate €43

- Hire of Conference Room with Natural Light & WiFi
- Plasma Screen & Projector
- Flipchart & Stationery
- Iced Water
- Morning Tea & Coffee with Pastries
- Daily Newspaper in Meeting Rooms
- 3 Course Lunch
- Afternoon Tea & Coffee with Homemade Cookies
- Reserved Car Parking for Organiser

24 Hour Delegates €143

- Overnight Accommodation in a Superior Room with Full Irish Breakfast
- Hire of Conference Room with Natural Light & WiFi
- Plasma Screen & Projector
- Flipchart & Stationery
- Iced Water
- Morning Tea & Coffee with Pastries
- Daily Newspaper in Meeting Rooms
- 3 Course Lunch
- Afternoon Tea & Coffee with Homemade Cookies
- 4 Course Dinner
- Reserved Car Parking for Organiser

All Delegate Rates are based on a minimum of 12 Delegates

Create your own...

Food & Beverage Options

Clanard Court Hotel offers you an excellent choice of in house dining areas for refreshment breaks during the course of your meeting/conference. We would be delighted to discuss your requirements with you and suggest the most suitable area giving consideration to your time and needs.

Below is a sample of some of the more popular requests from conference organisers, however we have a host of options available and will leave no stone unturned in order to find the perfect package for you.

WORKING BREAKFAST

A choice of Pastries, Fresh Fruit Juices, Tea or Coffee	€ 6.50
Selection of Fresh Fruit Smoothies & Cereal Bars	€ 6.50
Continental Buffet Breakfast	€ 8.95
Full Irish Breakfast	€ 10.95

MORNING AFTERNOON COFFEE BREAKS

Freshly Brewed Tea / Coffee	€ 2.00
Freshly Brewed Tea / Coffee with a selection of Biscuits	€ 2.95
Freshly Brewed Tea / Coffee served with	
Homemade Scones, Jam & Cream or Pastries & Danishes & Muffins	€ 4.95

LUNCH OPTIONS

Light Lunch: Homemade Soup, Selection of Sandwiches, Tea / Coffee	€10.95
Main course, Tea or Coffee	€13.95
3 Course Lunch (Starter or Dessert, Main course, Tea/Coffee)	€17.95
Full Lunch (Soup, Main Course, Dessert, Tea / Coffee)	€21.95

Alternative options such as a buffet lunch or working lunch may be organised. The price will depend on individual requirements.

FINGER FOOD

From €7.95

A wide range of options are available. Every menu can be tailored to your requirements.

EVENING MEALS *(Menus can be tailored and priced to your requirements)*

Dinner in the Bailey's Brasserie

Private Dinner Party in The Duke of Leinster, Fitzgerald Suite or The Courtyard

Conferences and Incentives

Whether you require a small meeting or an international conference our team will work with your conference organiser, to provide the professional services you require, enabling them to focus their care and attention on the conference content

We offer you excellent people and personal service to make your event a memorable success.

The experience and knowledge of the team will be the comfort factor that your conference will fulfil its goals and objectives.

The Team can assist you with any of the following:

Conferences

- Accommodation
- Meet & greet services
- Transportation
- Audio-visual services and production
- Conference packs
- Food and beverage co-ordination
- Social events – welcome receptions and gala dinners
- Accompanying persons programmes, tours and field trips
- Entertainment and cultural events

Incentives

- Tailor Made Programmes
- Accommodation
- Meet & Greet Assistance
- Local Assistance & Guides
- Transfer Logistics
- Gala Dinners
- Music & Entertainment
- Production
- Theme Events
- Team-Building Activities
- VIP Arrangements
- Special Events
- Product Launches
- Sporting & Cultural Events

Overleaf are some suggestions and ideas for Group Activities.

There are endless possibilities. The choice is yours!!

Group Activities

Burtown House & Gardens

Burtown House & Gardens is located just minutes from the Hotel and provides an ideal place to spend an afternoon exploring lush flower, vegetable and woodlands gardens with beautiful park and farmland walks. Stop by their cafe and relax with a tea or coffee and some yummy baked treats to cap off a leisurely afternoon.

Athy Heritage Centre

Established to celebrate the vibrant socio-historic legacy of the area. It houses material and audio-visual programmes that chronicle the ancient, medieval and post 16th Century lives of people from Athy its hinterland. It is also home to a permanent exhibition to Ernest Shackleton, the Great Polar Explorer, including his sledge and a 15-foot model of his ship Endurance.

Kildare Town

In Kildare Town Learn about the mythology of Fionn Mac Cumhaill and St Brigid, patroness of the Gaels. Key stops along the route include St Brigid's Cathedral, a Norman tower house, the site of the Turf Club, and the twelfth century Franciscan Abbey.

Japanese Gardens

A living monument to the meeting of Eastern and Western cultures in a Western setting. The symbolism of life the garden portrays traces the journey of a soul from Oblivion to Eternity and the human experience of its embodiment as it journeys by paths of its own choice through life. Visit www.irishnationalstud.ie for more information.

Punchestown Racecourse

The Home of Irish National Hunt racing since 1827 Punchestown Racecourse hosts 18 meetings throughout the year. Set amidst 450 acres of magnificent Irish countryside in the heart of Ireland's thoroughbred county it is the perfect place to enjoy the excitement of a day at the races. The highlight being the five day Irish National Hunt Festival held at the end of April every year. View the fixtures list at www.punchestown.com.

Shopping

Kildare Retail Outlet Village is only 15 minutes from the hotel. Home to over 50 designer boutiques at up to 60% off RRP every day, all year round. We can arrange a VIP welcome for your group at Kildare Village with exclusive shopping offers and access to their VIP shopping lounge. Visit www.kildarevillage.com for more information

Newbridge Silverware is just 20 minutes from the hotel. The unique history of the company provides a wealth of tradition, craftsmanship and experience, while a contemporary and fresh attitude to marketing and design puts Newbridge Silverware on the cutting edge of modern living. Visit www.newbridgesilverware.com

Group Activities

Golf & Outdoor Activities

Dunmurry Springs

One of Ireland's most exciting and original new golf projects in recent years. Born out of a passion to utilise a very special site beside The Curragh, Mel Flanagan and his team have gone about crafting a classic piece of golf architecture in the mould of the great romantic courses like Sunningdale and Gleneagles, but with a distinctly Irish blend

Athy Golf Club

Formed in 1906 as a nine hole course and was extended to 18 holes in 1993. The course had a Par of 71 and it extended to 6,400 yards from the medal tees.

Cardenton House Golf Course

Well laid out course which is sand based and set in nicely maturing parkland. The course is an 18 hole course (16 Par 3, 2 Par 4) on a 50 acre site.

Angling

The town is a terminal point for a branch of the Grand Canal, which along with the River Barrow offers ideal opportunities for fishing, canoeing and pleasure boat cruising. Athy is located 8 miles from the angling centre of Vicarstown.

Annamoe Trout Fisheries Game Angling, 0404 45470

Angling for all Salmon Fishing 0402 36552

Adventure Sports

There are a range of adventure activities only a short drive from the hotel ranging from Quad Biking to outdoor fun parks.

Country Quads, 059 972 4624, www.countryquads.net

Go with the flow River Adventures, 057 913 1307, www.gowiththeflow.ie

Skirmish, 1890 31307, www.skirmish.ie

Mondello Park Racing Circuit ,045 860 200, www.mondello.ie

Walking

Many of the riverbank areas are open to walkers as are a number of canal walks and these can be taken in whole or in part. There are a number of famous walks within easy reach of The Clanard Court such as South Leinster Way, Mount Leinster, Blackstairs Mountains and The Ridge, Stradbally and Saint Fiachra's Garden.

Cruising

The Barrow River provides many exciting activities for both the passive and the active water enthusiasts. It is probably one of the least known, yet magical inland waterways in Europe and it meanders through a scenic valley steeped in History and Heritage.

Barrowline Cruisers, 059 913 2545, www.barrowline.ie

Valley Boats, 059 973 24945

Conference Room Layouts

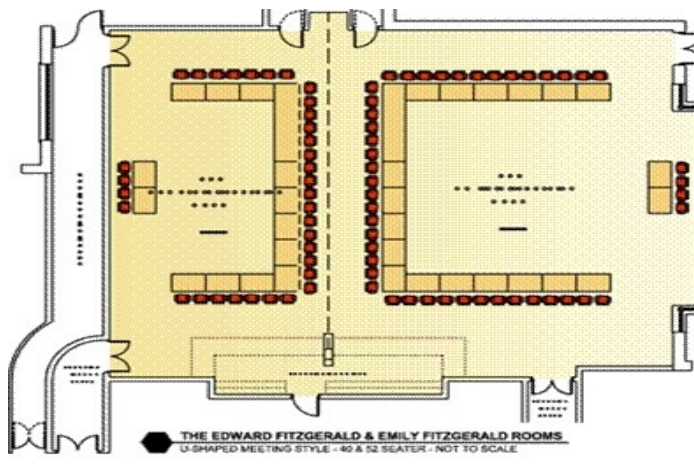
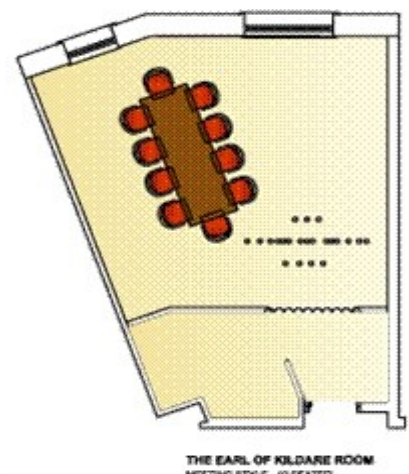
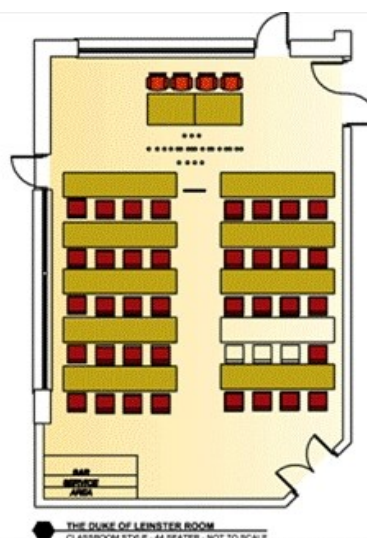
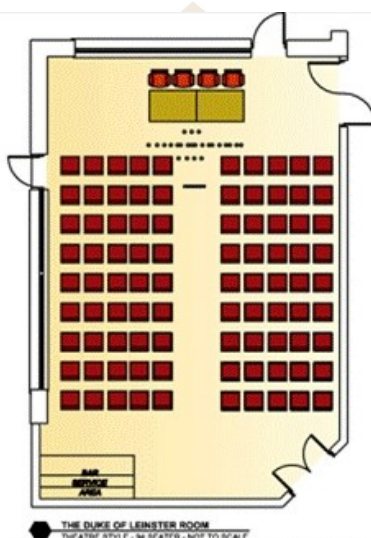
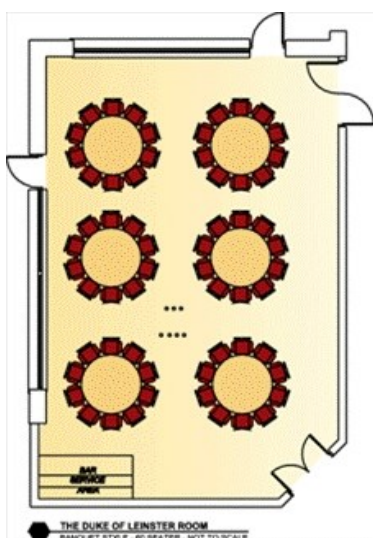
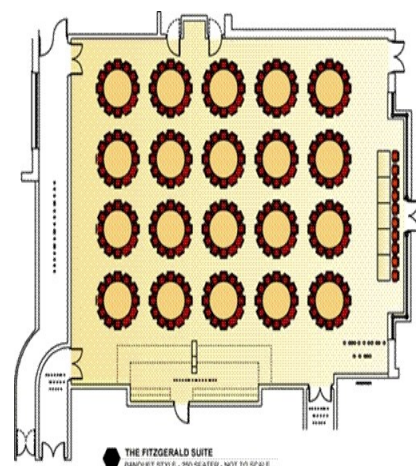
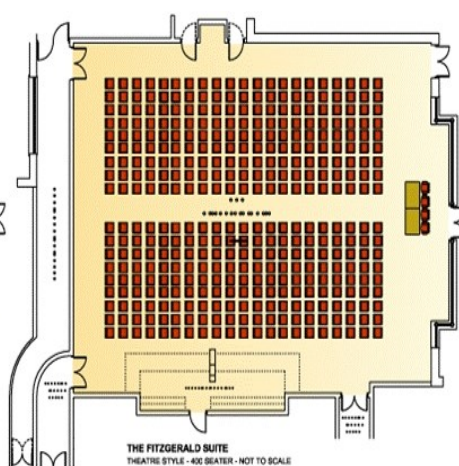
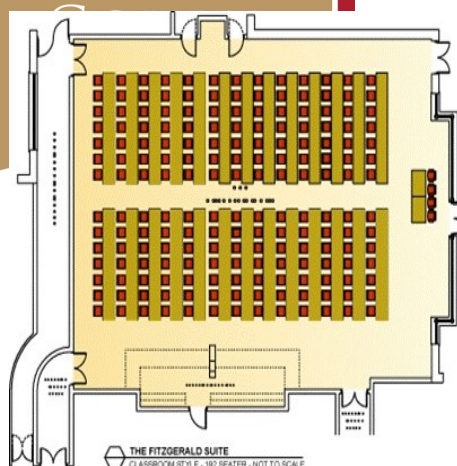

Quick Reference Guide Conference Facilities

CONFERENCE ROOMS			ROOMS		FREE PARKING		PRE-CONFERENCE RECEPTION AREA		BUSINESS SERVICES	
			6		YES 250 Cars		YES		YES	
Room .	Theatre	Banquet (Round Tables)	Class- room	U- Shape d	Board- room	A/C	AV	Ceiling Height Ap- prox.	Broad- band / WiFi	Metres Sq
Duke of Leinster Suite	80	72	40	30	20	✓	✓	3.2m	✓	83
Edward Fitzgerald Suite	150	84	60	40	-	✓	✓	3.6m	✓	118
Emily Fitzgerald Suite	250	160	110	50	-	✓	✓	3.6m	✓	195
*Fitzgerald Suite	450	272	190	-	-	✓	✓	3.6m	✓	313
Woodstock Boardroom	70	46	24	20	20	✓	✓	2.7m	✓	54
The Courtyard	100	130	60	-	-	✓	✓	2.7m	✓	
Earl of Kildare Room	20	-	-	10	10	✓	✓	2.8m	✓	29

*** Note:** Fitzgerald Suite is the Emily and Edward Suites combined. Larger capacities can be accommodated for banqueting by using alternative seating